

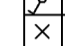











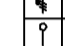

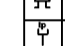

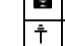



Renvooi

-  metselwerk bruin of roodbruin of wit geschilderd
-  wit geschilderd metselwerk
-  isolatie
-  prefab beton
-  geïsoleerd houten gevelelement
-  lichte scheidingswand
-  metal-stud wand
-  houten kozijn
-  binnendeurkozijn
-  kruipruimte 800x600
-  wp warmtepomp
-  mv mechanische ventilatie
-  wm opstelplaats wasmachine
-  vrT verdekt ventilatorrooster
-  vrG glasventilatorrooster
-  vrD ventilatorrooster in dakraam

	1 pofschakelaar
	serie schakelaar
	wissel schakelaar
	lichtpunt
	wandlicht aansluitpunt
	wandlicht aansluitpunt
	dubb. wandcontactdoos hor
	dubb. wcd meterkast opbouw
	enkele wcd
	enk. wcd met usb aansl.
	aansluitpunt 230V
	leiding koos (controle draad)
	Leiding bedraad t. bv. Th
	bedrukker
	Signaalgever deurbel
	enk. wandcontactdoos tel
	enk. wandcontactdoos cal
	rookmelder optisch
	verdelkast
	centraal aansluitpunt
	aardchem



Voorgevel



Achtergevel

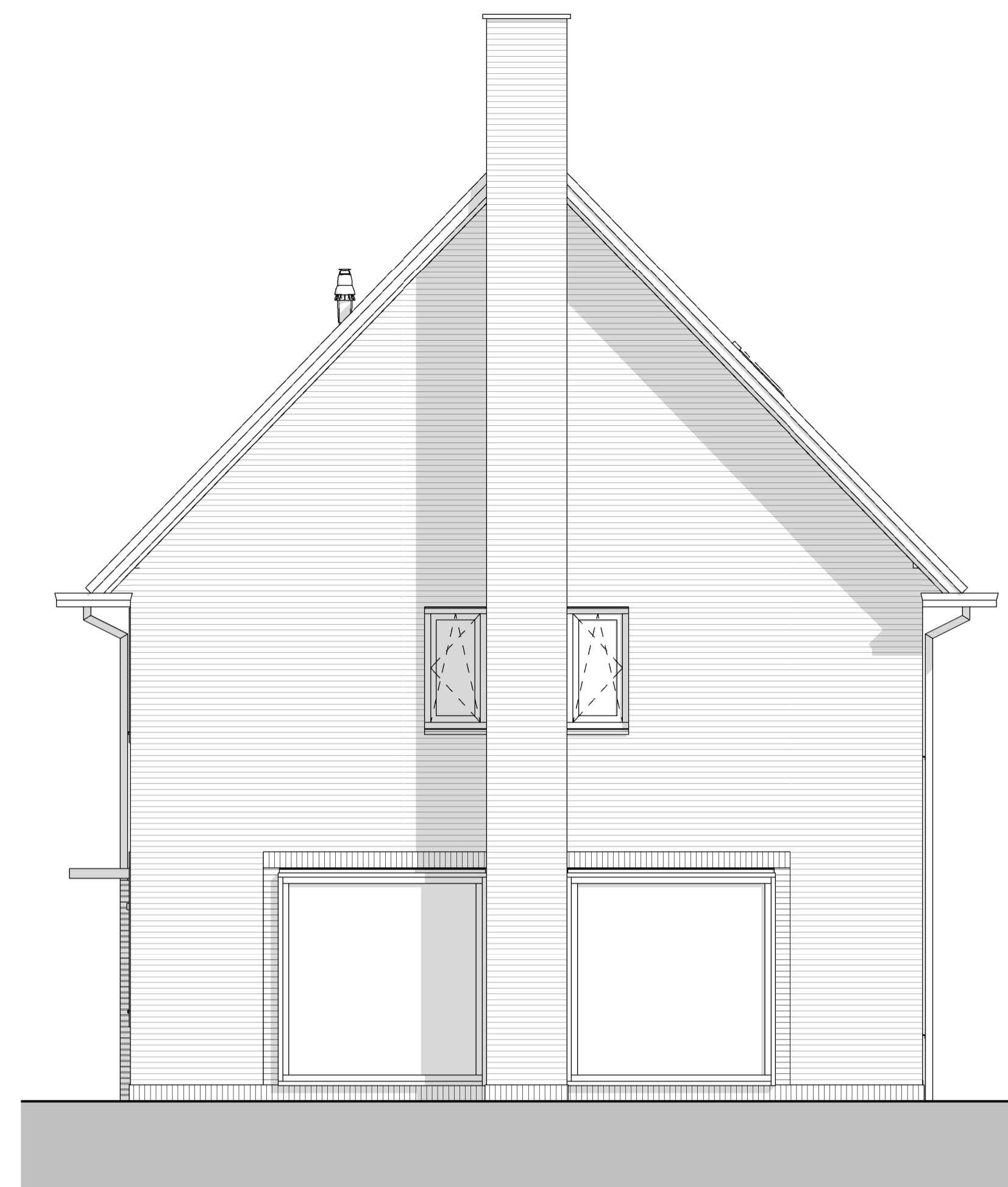

Rechtergevel

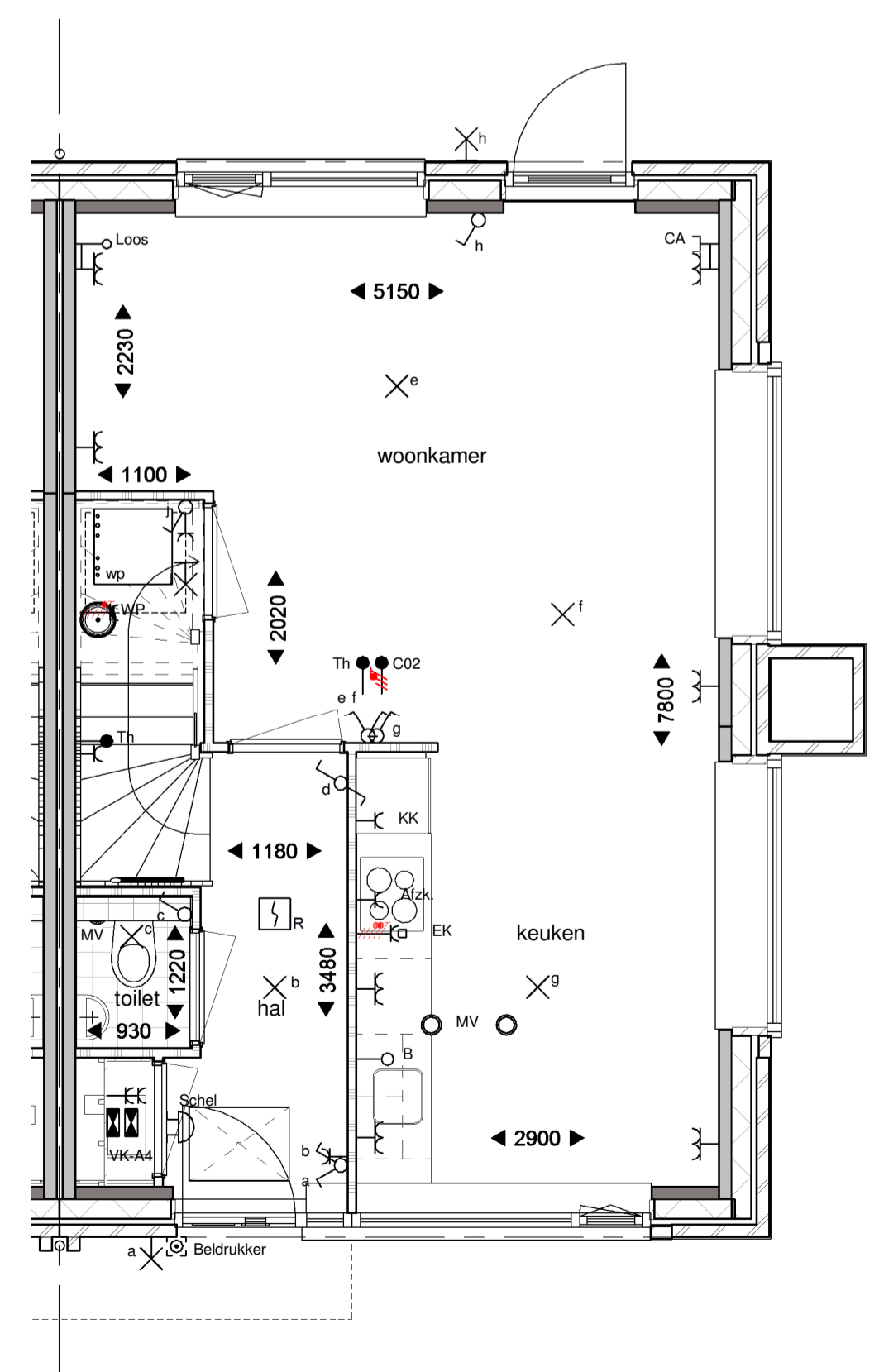

Begane grond

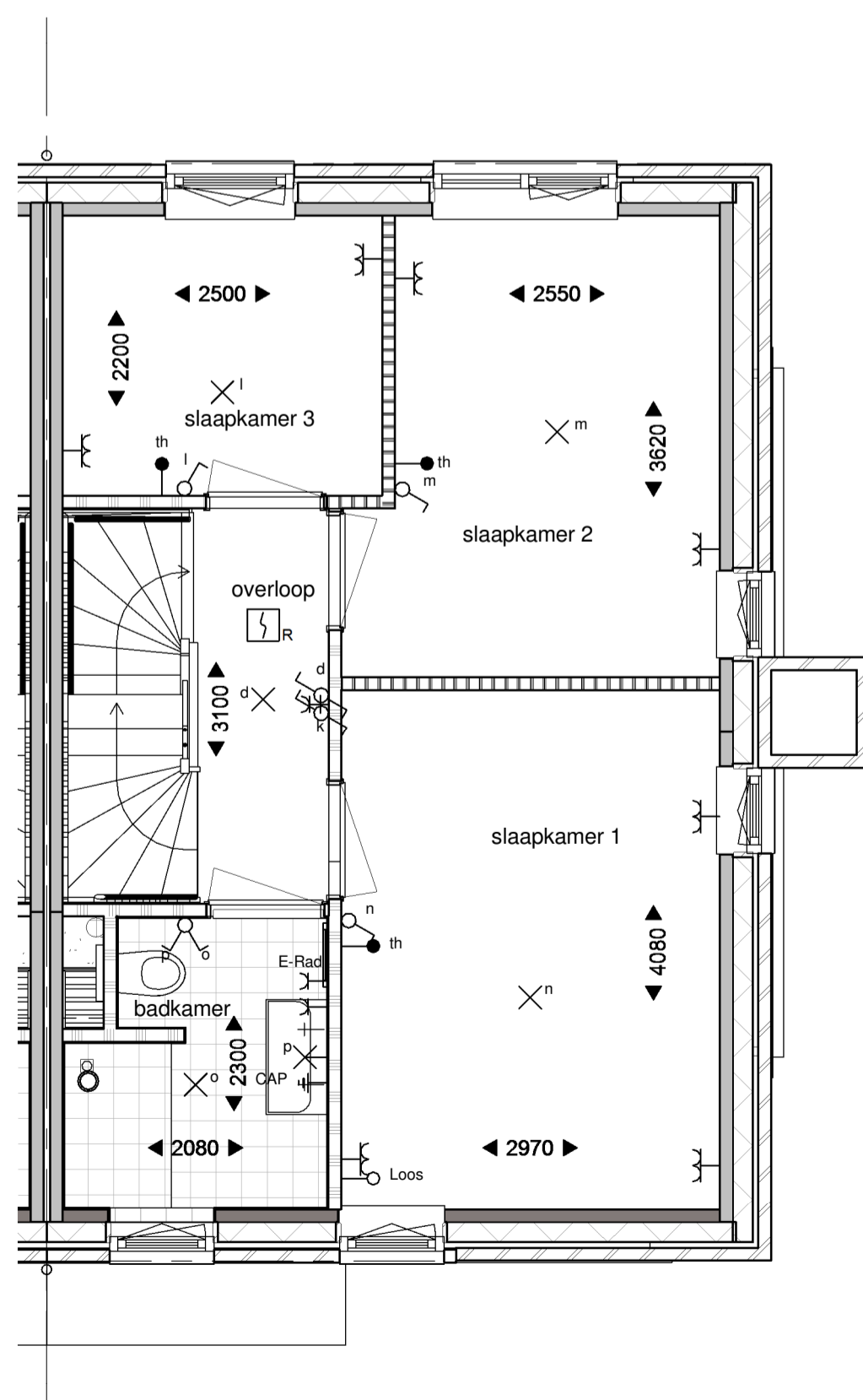

Eerste verdieping

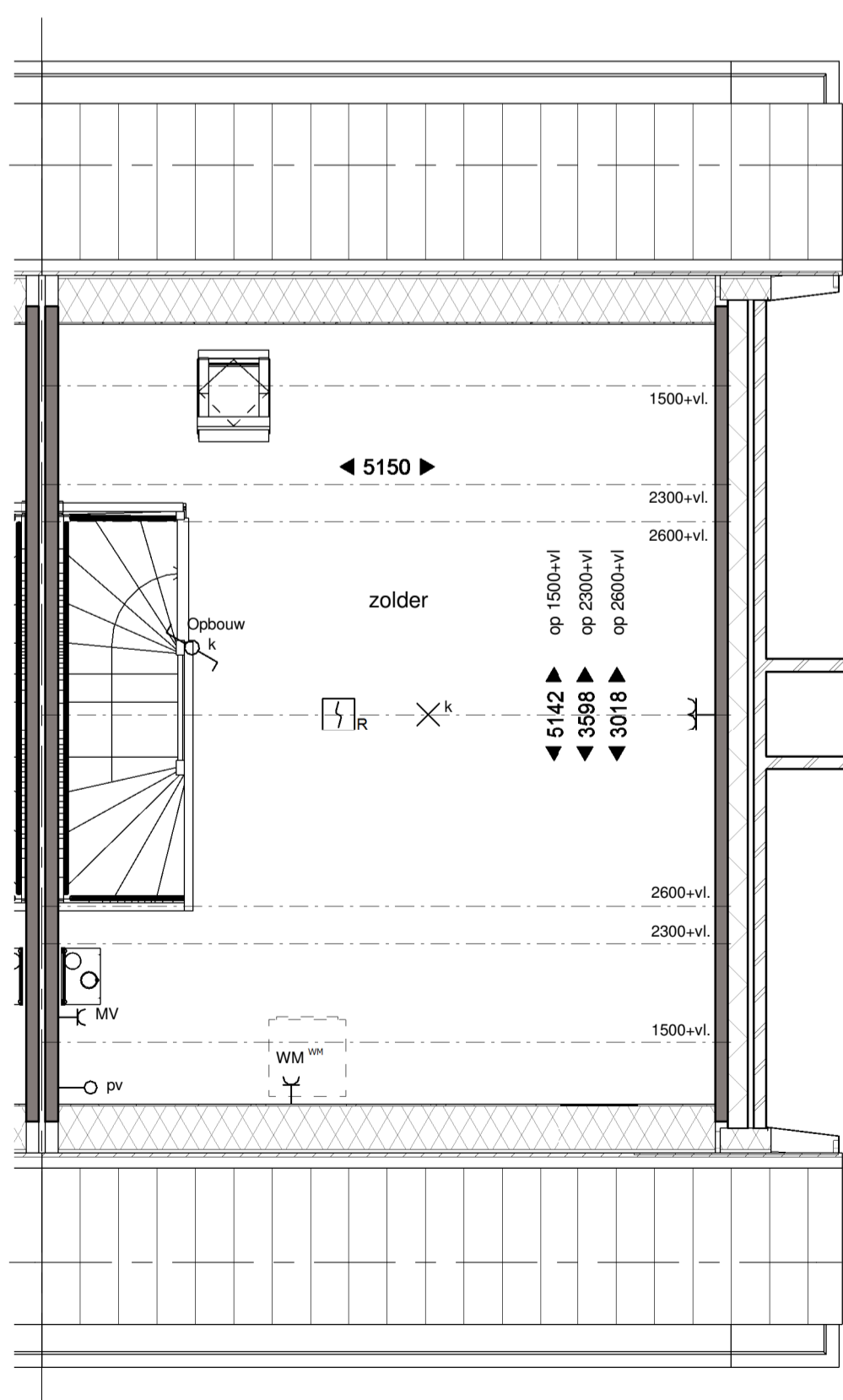

Tweede verdieping

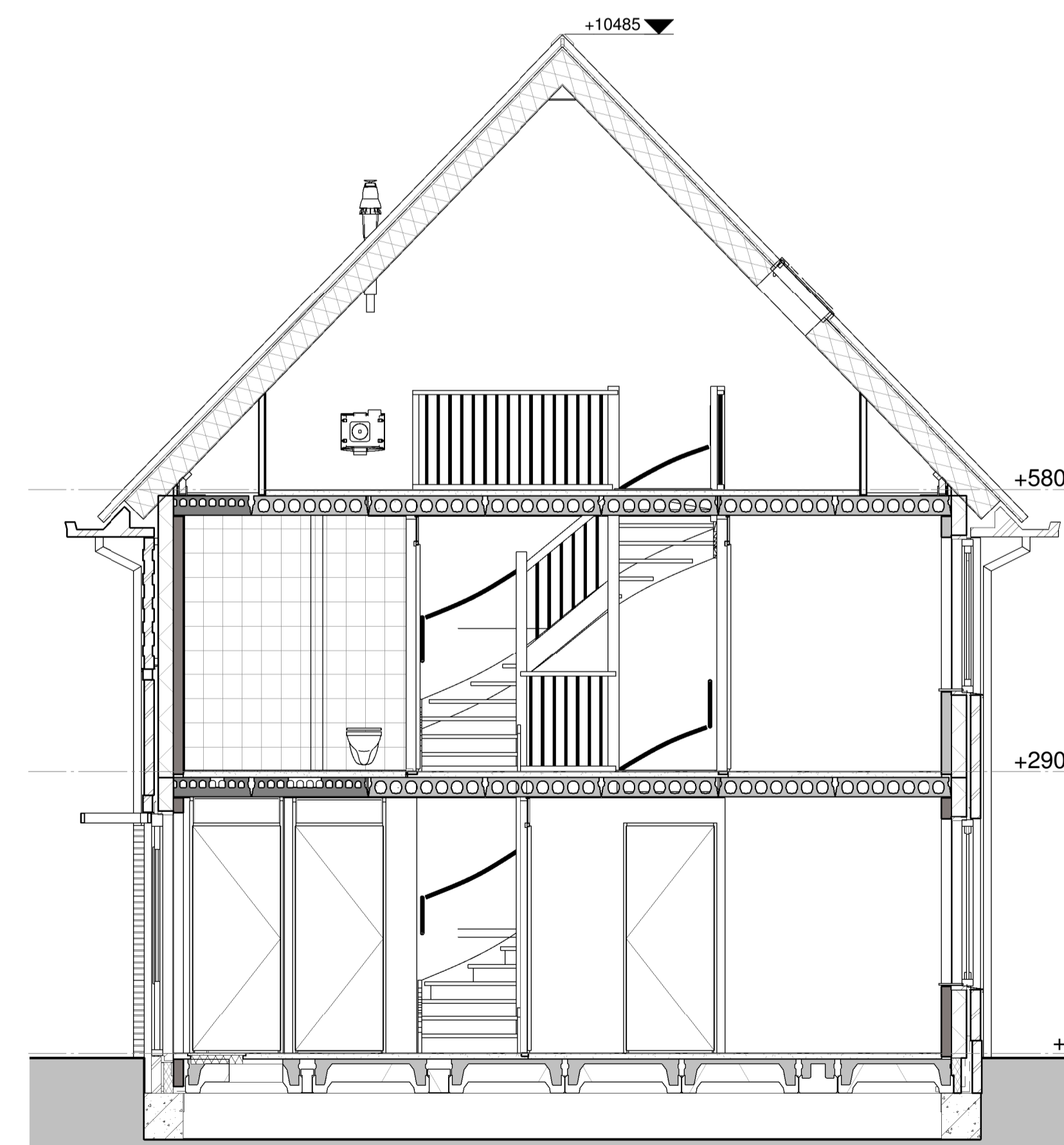

Doorsnede



project:
Nieuwbouw 249 woningen
Kortenoord Wageningen
aanvraag:
Type A1s
datum:
21-10-2016
architect:
As indicated